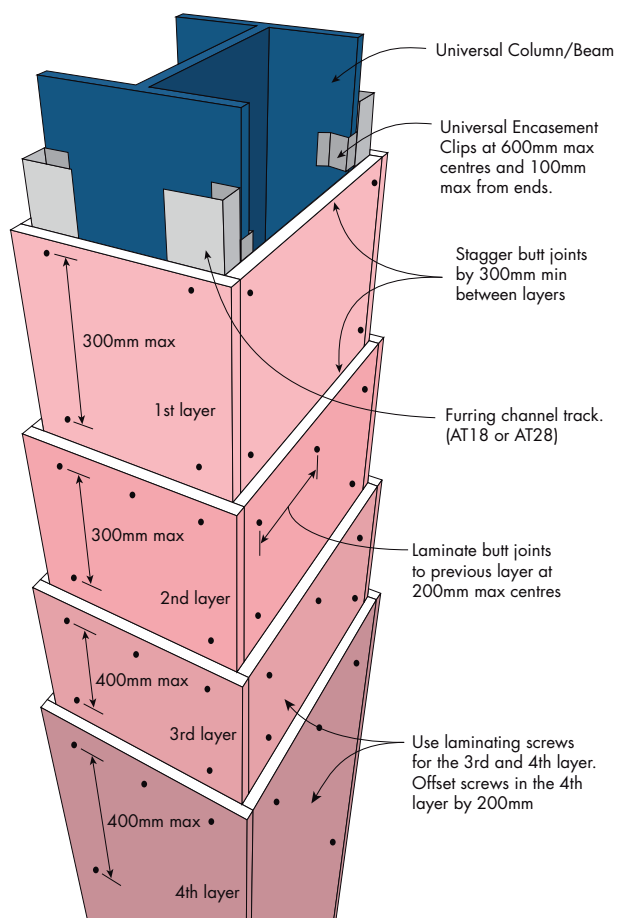
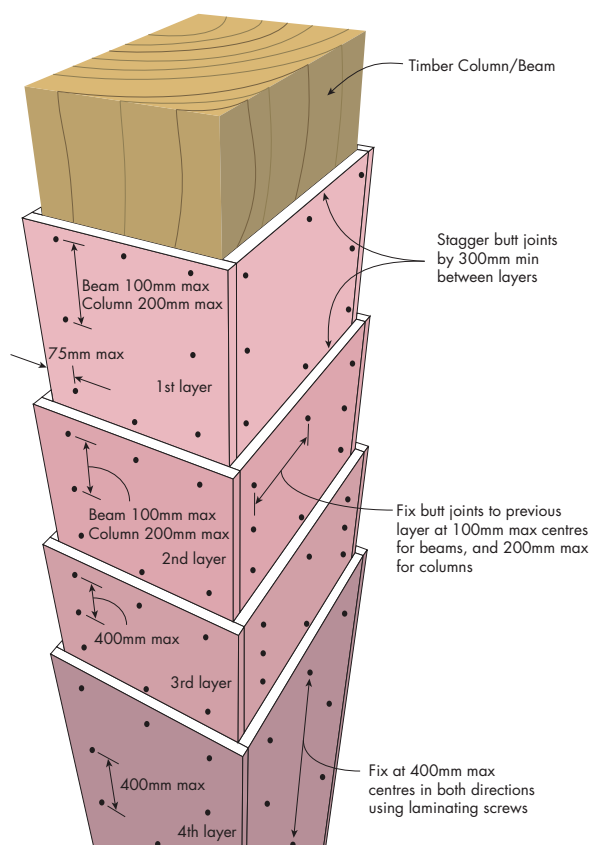

FIGURE 1 Steel Column/Beam



Fixing	Screw Only Method
Fasteners	All screws 50mm max from sheet edges
Edges along length	All layers: Fix at 300mm max centres. 3rd layer: Either screw to furring channel track or use laminating screws. 4th layer: Use 38mm -10g laminating screws.
Butt joints	Single Layer System: Install furring channel track behind sheet joints and fix at 200mm max centres. Multiple Layer Systems: Laminate to previous layer at 200mm max centres. Stagger butt joints by 300mm min between layers.

FIGURE 2 Timber Column/Beam



Fixing	Screw Only Method
Fasteners	All screws 75mm max from sheet edges.
Beam - Edges Along Length	All layers: Fix at 100mm max centres. Also fix at 450mm max centres in the centreline of the sheet for all layers. 3rd layer: Either screw to timber beam or use laminating screws. 4th layer: Use 38mm -10g laminating screws.
Column - Edges Along Length	All layers: Fix at 200mm max centres. 3rd layer: Either screw to timber column or use laminating screws. 4th layer: Use 38mm -10g laminating screws.
Butt Joints	Either screw to column/beam or laminate to previous layer at 200mm max centres. Stagger butt joints by 300mm min between layers.